

Cam and Groove Configurations

Configurations are representative of the Dixon® line of cam & groove.

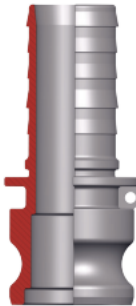

Type A
female NPT x male adapter



Type E
male adapter x hose shank

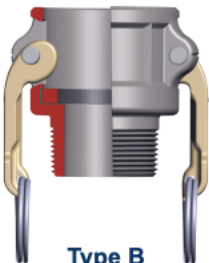

Type B
female coupler x male NPT

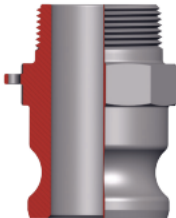

Type F
male NPT x male adapter

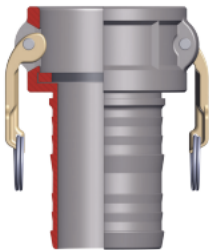

Type C
female coupler x hose shank

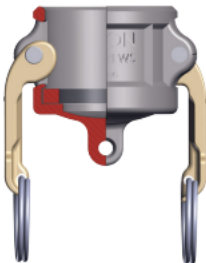

Type DC¹
dust cap

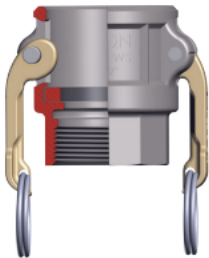

Type D
female coupler x female NPT



Type DP¹
dust plug

¹ Dust caps and dust plugs are **not** to be used in pressure applications for safety and environmental reasons.

Under no circumstances should cam & groove couplings be used for compressed air or steam service!

